

PRINTABLE INFO SHEET

Series: Manorwood Two Story Homes
Model: 6M3018-N Burlington

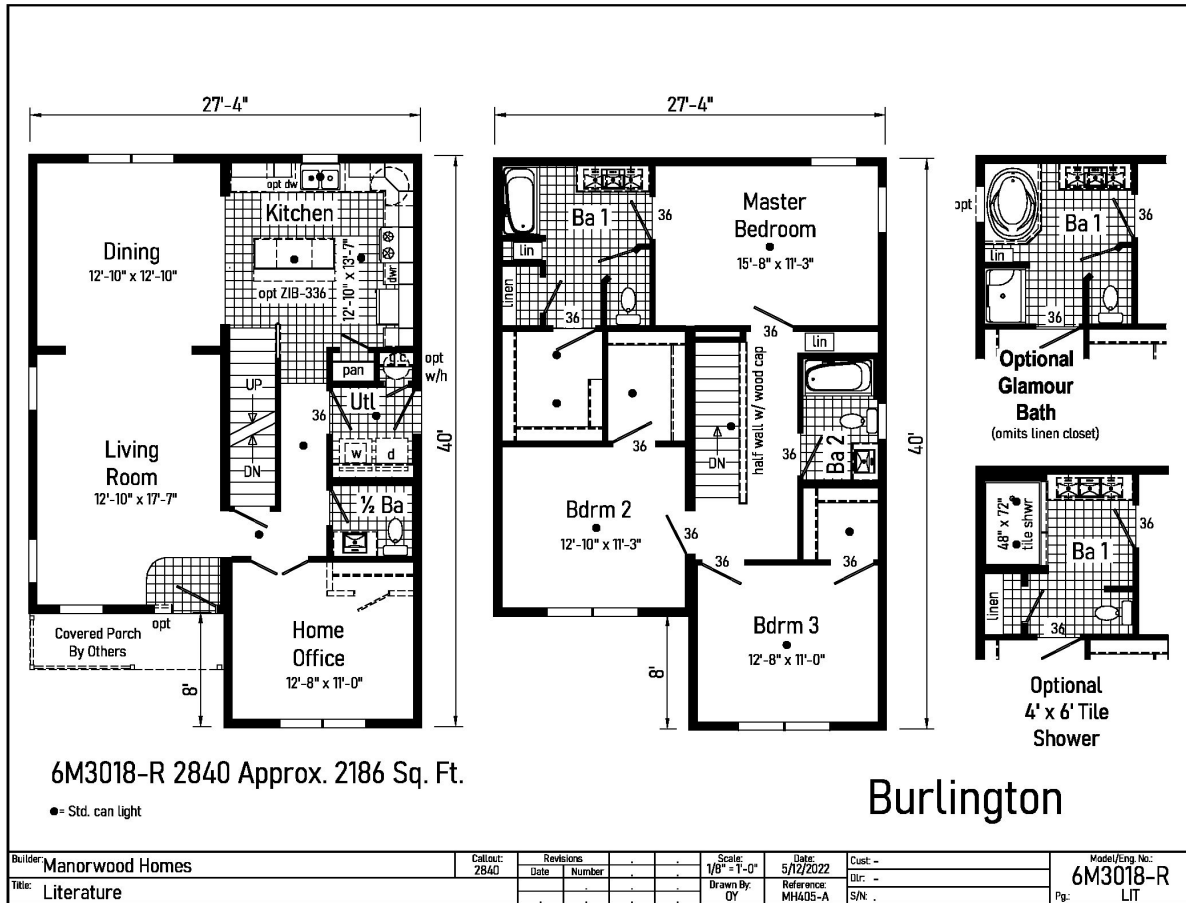

About This Model

Style: 2-Story / Bedrooms: 3 / Bathrooms: 3 / Square Feet: 1872

CUSTOMER CONTACT

Notes: _____

PRINTABLE INFO SHEET

Series: Manorwood Two Story Homes

Model: 6M3018-N Burlington



Standards & Features

FLOOR CONSTRUCTION

2X10 Floor Joists 16" O.C.
3/4" T&G OSB Floor Decking
3/4" OSB Floor Decking on 2nd Floor
Open Web Floor Trusses in Wet Areas of 2nd Floor
Insulated Basement Stairwell

EXTERIOR WALLS

2X6 Studs 16" O.C.
Double 2X6 Top Plates
8' Wall Height
7/16" Structural OSB Sheathing
Whole House Wind Wrap
Vinyl Siding

INTERIOR WALLS

2X4 Interior Wall Studs 24" O.C.
2X4 Marriage Wall Studs 16" O.C. with
7/16" OSB Sheathing
Primed 1/2" Smooth Drywall Throughout

ROOF AND CEILING

5/12 Roof Pitch with 12" Eaves
Pre-Engineered 40# Roof Trusses 24" O.C.
90 MPH Wind Exposure C Wind Load Design
Ice Shield
7/16" Structural OSB Roof Decking
Shingle Over Ridge Vent Ventilation
Vented Vinyl Soffit
Aluminum Fascia
Aluminum Drip Edge on all Roof Edges
Smooth Drywall Ceiling
Architectural Shingles

ROOF AND CEILING (continued)

(Limited Lifetime Warranty)
Synthetic Roof Underlayment

INSULATION

Exterior Walls R-23 Fiberglass Insulation
Ceiling R-38 Fiberglass Batt Insulation

EXTERIOR DOORS AND WINDOWS

3/0 x 6/8 6-Panel Fiberglass Door with Nickel Hardware & Composite Jamb at Front & Rear Primed White
Door Pan on Exterior Doors
Low-E Vinyl Insulated Single Hung Argon Filled White Windows & Mulled where Applicable
Front & Rear Door Kwikset Lockset with Smart Key
15" Raised Panel Shutters Door Side

INTERIOR DOORS AND TRIM

2-Panel Painted White Interior Doors w/ Lever Passage Sets and 3 Mortise Hinges
36" Interior Doors & Where Available Privacy Locks on Bedroom & Bath Doors
Door Stops
White Wood Colonial Moulding Package
Wire Shelving all Closets and Washer/Dryer Area
Brushed Nickel Hardware

FLOOR COVERING

Congoleum Vinyl Flooring (Kitchen, Baths, Utility and Foyer)
25 oz. Carpet with Stain Protector
Carpeted Stairs with Railing & Handrail
5# Rebond Carpet Pad

CUSTOMER CONTACT

Notes:

PRINTABLE INFO SHEET

Series: Manorwood Two Story Homes

Model: 6M3018-N Burlington



Standards & Features (continued)

KITCHEN

- Overlay Classic Craft Cabinetry
- KCMA Certified
- Hardwood 5-Piece French Country Oak, Rustic Elm, or Barnwood Oak Mission Flat Panel Doors
- Craftsman Cabinet Crown Moulding
- 42" Height Kitchen Overhead Cabinets
- Dovetailed Drawers
- Soft Close Undermount Drawer Guides
- Laminate Countertops
- 8" Deep Stainless Steel Kitchen Sink Brushed Nickel Metal Faucet with Sprayer Power Range Hood
- Transitional Cabinet Pulls (Brushed Nickel or Black)
- Corner Base Lazy Susan (where applicable)
- USB Receptacle II

BATHS

- Brushed Nickel Metal Faucets
- Anti-Scald Valves for Showers & Tubs
- Laminate Countertops
- Square China Lavs
- Elongated Toilets
- Lighted Exhaust Fans with Insulated Ducts
- All Baths
- 2-Arm Light at Vanity
- 60" One Piece Fiberglass Tub/Shower
- Fiberglass Soaker Tub (per plan)
- 48" One Piece Fiberglass Shower with Glass Shower Enclosure (per plan)
- Double Bowl Bath Vanity (per plan)

BATHS (continued)

- Black Framed Mirrors
- Linens with Drawers (where available)

ELECTRICAL

- 200 AMP Electrical Service with 40/40 Panel Box
- 2 GFI Exterior Receptacles with In-Use Covers
- Light at Front Exterior Door Patina Lantern
- Light at Rear Exterior Door
- Recessed LED Lighting T/O
- Smoke Detectors with Battery Back-up
- Wire for Electric Range
- Carbon Monoxide Detector(s)
- Electric Doorbell at Front Door

PLUMBING

- PEX Water Lines Stubbed Through Floor
- Drain, Water and Vents Stubbed Through Floor
- Shut Off Valves for all Sinks, Lavs and Toilets
- Plumb, Wire and Vent for Washer/Dryer
- 2nd Floor PEX Supply Loop and PVC
- Drain Lines
- Oetiker Clamps

10 YEAR RESIDENTIAL WARRANTY

CUSTOMER CONTACT

Notes:
