

PRINTABLE INFO SHEET

Series: Coastal Homes

Model: 6M3011-R Atlantic View

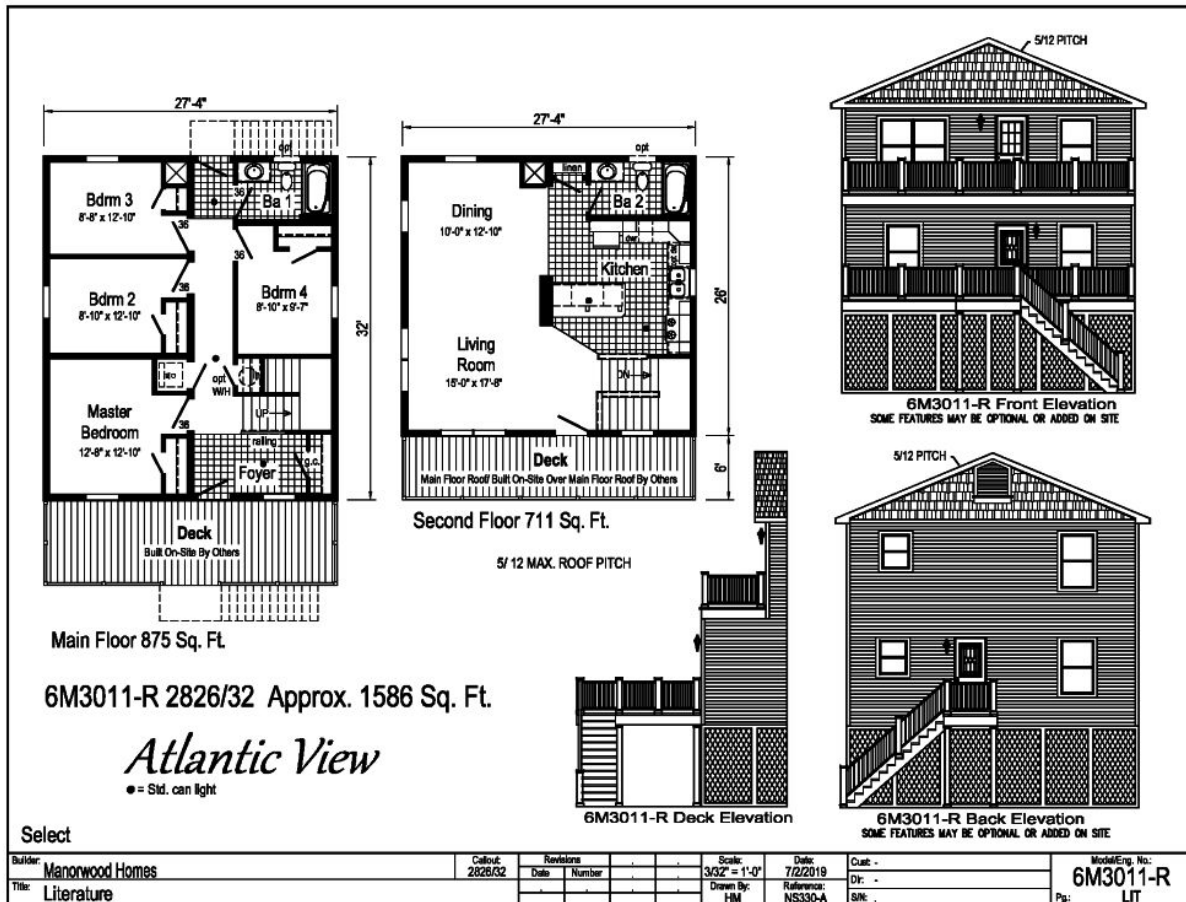

About This Model

Style: 2-Story / Bedrooms: 4 / Bathrooms: 2 / Square Feet: 1586

CUSTOMER CONTACT

Notes:

PRINTABLE INFO SHEET

Series: Coastal Homes

Model: 6M3011-R Atlantic View



Standards & Features

FLOOR CONSTRUCTION

2X10 Floor Joists 16" O.C.

$\frac{3}{4}$ " T&G OSB Floor Decking

Insulated Basement Stairwell

EXTERIOR WALLS

2X6 Studs 16" O.C.

Double 2X6 Top Plates

8' Wall Height

Structural OSB Sheathing

Whole House Wind Wrap

Vinyl Siding

INTERIOR WALLS

2X4 Interior Wall Studs 24" O.C.

2X4 Marriage Wall Studs 16" O.C. with

OSB Sheathing

Primed $\frac{1}{2}$ " Smooth Drywall Throughout

ROOF AND CEILING

8' Flat Ceiling

5/12 Roof Pitch with 12" Eaves

7/12 Roof Pitch with 12" Eave (certain models)

Pre-Engineered 40# Roof Trusses 24" O.C.

90 MPH Wind Exposure C Wind Load Design

Ice Shield

Structural OSB Roof Decking

Shingle Over Ridge Vent Ventilation

Vented Vinyl Soffit

Aluminum Fascia

Aluminum Drip Edge on all Roof Edges

Smooth Drywall Ceiling

Architectural Shingles

(Limited Lifetime Warranty)

ROOF AND CEILING (continued)

Synthetic Roof Underlayment

INSULATION

Exterior Walls R-21 Fiberglass Insulation

Ceiling R-38 Fiberglass Batt Insulation

PLUMBING

PEX Water Lines Stubbed Through Floor

Drain, Water and Vents Stubbed Through Floor

Shut Off Valves for all Sinks, Lavs and

Toilets

Plumb, Wire and Vent for Washer/Dryer

Oetiker Clamps

EXTERIOR DOORS AND WINDOWS

3/0 x 6/8 6-Panel Fiberglass Door with Nickel

Hardware & Composite Jambs at Front

& Rear Primed White

Door Pan on Exterior Doors

Low-E Vinyl Insulated Single Hung Argon Filled

White Windows & Mulled where Applicable

Front & Rear Door Kwikset Lockset with

Smart Key

15" Raised Panel Shutters Door Side

INTERIOR DOORS AND TRIM

2-Panel Painted White Interior Doors w/

Lever Passage Sets and 3 Mortise Hinges

36" Interior Doors & Where Available

Privacy Locks on Bedroom & Bath Doors

Door Stops

White Wood Colonial Moulding Package

Wire Shelving all Closets and Washer / Dryer

Area

CUSTOMER CONTACT

Notes:

PRINTABLE INFO SHEET

Series: Coastal Homes

Model: 6M3011-R Atlantic View



Standards & Features (continued)

INTERIOR DOORS AND TRIM (continued)

Brushed Nickel Hardware

FLOOR COVERING

Congoleum Vinyl Flooring

(Kitchen, Baths, Utility and Foyer)

25 oz. Carpet with Stain Protector

5# Rebond Carpet Pad

KITCHEN

3/4 Overlay Classic Craft Cabinetry

- KCMA Certified

Hardwood 5-Piece French Country Oak or

Barnwood Oak Mission Flat Panel Doors

Craftsman Cabinet Crown Moulding

42" Height Kitchen Overhead Cabinets

Dovetailed Drawers

100# Undermount Drawer Guides

Laminate Countertops

8" Deep Stainless Steel Kitchen Sink

Brushed Nickel Metal Faucet with Sprayer

Power Range Hood

Transitional Cabinet Pulls (Brushed Nickel or Black)

Corner Base Lazy Susan (where applicable)

USB Receptacle

Soft Close Drawers

BATHS

Brushed Nickel Metal Faucets

Anti-Scald Valves for Showers & Tubs

Laminate Countertops

China Lavs

Elongated Toilets

Lighted Exhaust Fans with Insulated Ducts

BATHS (continued)

2-Arm Light and Framed Mirror at Vanity

60" One Piece Fiberglass Tub/Shower

Fiberglass Soaker Tub (per plan)

48" One Piece Fiberglass Shower with Glass

Shower Enclosure (per plan)

Double Bowl Bath Vanity (per plan)

Framed Mirrors

Linens with Drawers (where available)

ELECTRICAL

200 AMP Electrical Service with 40/40 Panel Box

2 GFI Exterior Receptacles with In-Use Covers

Craftsman Light at Front Exterior Door

Patina Lantern Light at Rear Exterior Door

Recessed LED Lighting T/O

(Excludes Bedroom Ceiling Lights)

Smoke Detectors with Battery Back-up

Wire for Electric Range

Carbon Monoxide Detector(s)

Electric Doorbell at Front Door

CAPE MODELS

12/12 Roof Pitch with 12" Eaves

12/12 and 7/12 Combination Roof Pitch
with 12" Eaves

Close-Off Package for 2nd Floor Including

Interior Door and Partitions for On-Site Install

3/4" OSB Floor Decking for 2nd Floor &—

Shipped Loose

(2)‘110' Electrical Circuits to Junction Boxes

for Future Lights &—; Electrical Circuit to

Junction Box for Future Smoke Detector(s)

CUSTOMER CONTACT

Notes:

PRINTABLE INFO SHEET

Series: Coastal Homes

Model: 6M3011-R Atlantic View



Standards & Features (continued)

CAPE MODELS (continued)

Electrical Circuit to Junction Box for
Future 3-Way Light on 2nd Floor
Rough-In Plumbing for Future Bath
Stairs with Railing, Handrail and Carpet
Shipped Loose
(2nd Floor Gable End Windows Optional)
10 YEAR RESIDENTIAL WARRANTY

CUSTOMER CONTACT

Notes:
